

groundtech ISO-DECK

Acoustic Isolation Deck For Use On Timber Sub-Floors

APPROVED DOCUMENT E

- Suitable for use between lightweight internal partitions
- Cost effective FFT5 compliant product
- Ideal for timber frame construction
- Minimises construction height

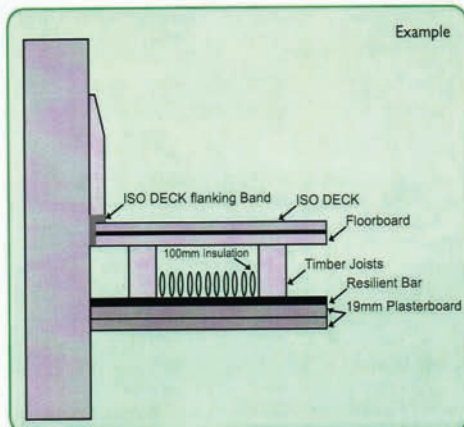

DESCRIPTION

ISO-Deck is a resilient platform floor system designed for use on timber sub-floors. At only 28mm thickness **ISO-Deck** minimises construction height while complying to Part E of the building Regulations. Extremely easy to install, the product is economical and available off the shelf for immediate delivery nationwide.

ISO-Deck panels comprise of a 10mm resilient layer pre-bonded to 18mm or 22mm T & G flooring grade chipboard.

SPECIFICATION

Size	2400mm x 600mm TG4
Thickness	28mm or 32mm (Finished)
Part E Minimum requirement db_{w, L_w} :	17dB
ISO-Deck rating dB_{w, L_w} :	19dB

ACCESSORIES

ISO-Deck Flanking Band must be used with **ISO-Deck** to ensure compliance.

INSTALLATION

Installation guide sheet available upon request

Working in partnership with CDM - UK



ISO-LAY

Impact and Airborne Acoustic Underlay

APPLICATIONS

ISO-LAY acoustic underlay system is an effective and simple barrier designed to reduce both airborne and impact noise for existing floors and is suitable for use in both commercial and residential applications, efficiently limiting the passage of noise through the floor.

ADVANTAGES

- Improves airborne sound insulation
- Suitable for all final floor finishes
- Reduces impact noise transmission
- Tested on basic floor constructions
- Thin, easy to handle tiles
- Flexible and easily cut
- Simple to install
- Cost effective

PHYSICAL INFORMATION

Dimensions

Standard sizes: 1200mm x 1000mm

Example A (Timber)

TYPE	THICKNESS (mm)	WEIGHT (kg/m ²)	IMPACT PERFORMANCE (Max Allowed 62dB)
ISO-LAY Plus	15	16	53

Example B (Concrete)

TYPE	THICKNESS (mm)	WEIGHT (kg/m ²)	IMPACT PERFORMANCE (Min Required 17dB)
ISO-LAY	12	8	37

DESCRIPTION

ISO-LAY acoustic underlay is available in two formats:

ISO-LAY PLUS Designed for timber floor applications (but can also be used for concrete floors) that require additional airborne and impact noise insulation. This high performance composite is a sandwich laminate of two layers of NF60 acoustic barrier separated by a 9mm layer of Class O acoustic foam.

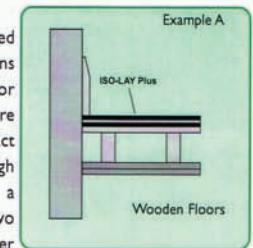

ISO-LAY Designed for concrete floor applications (but can also be used for timber floors) that require mainly impact noise insulation and to a lesser extent, airborne noise insulation. It is a two layer laminate, the upper being NF60 acoustic barrier supported by a 9mm layer of Class O acoustic foam.

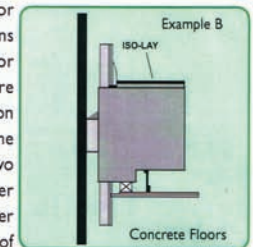

INSTALLATION

A full detailed installation guide sheet is available upon request.

Working in partnership with CDM - UK

